



# WLS20

## Generation III Dryer



### Features

- Capacity 20lb
- Stainless Steel Drum
- Easy Control
- Radax Technology
  - Maximum Heat Transfer
  - Low Energy Use
  - Fast Drying Time
- Large Door Opening

### Options

- Coin Or Manual
- Reversing Drum
- Full Control – Flexible Programming
- Residual Moisture Control Sensodry
  - Humidity Detection in %
  - Safe Drying of Delicate Linen
  - Ideal Combination for Soft Wash



# WLS20 technical data

Model	WLS20		
<b>Programmer</b>			
Easy Control	Standard		
Full Control	Optional		
<b>Load Capacity</b>			
Drum Capacity	9KG (20LB)		
Drum Volume	190 Litres		
Drum Diameter	760MM		
<b>Electrical Supply</b>			
Gas			
Electric	230V/50Hz – 400V3N/50Hz		
Steam			
<b>Drum Rotation</b>			
One Way Rotation	Standard		
Two Way Rotation	Optional		
<b>Air Flow</b>			
Air flow M3/h	Minimum 356 - Optimal 450		
Exhaust Diameter	150MM		
<b>Heating Data Gas</b>			
Heating Input	12.5KW		
BTU's	42,700 BTU's		
Gas Pipe Size (Inches)	¾"		
<b>Heating Data Electric</b>			
Heat Input	12.5 KW		
Electrical Load			
Amps Per Phase	20 Amps		
<b>Heating Data Steam</b>			
Steam Pressure	3-6 / 7-10 Bar		
Steam Connection			
(Inches)	¾"		
Condense Drain Connection			
(Inches)	¾"		
<b>Weight</b>			
Gross	180 KG		
Net	170 KG		
<b>Dimensions</b>	<b>Height</b>	<b>Width</b>	<b>Depth</b>
Unpacked	1460MM	795MM	815MM
Packed	1570MM	880MM	885MM

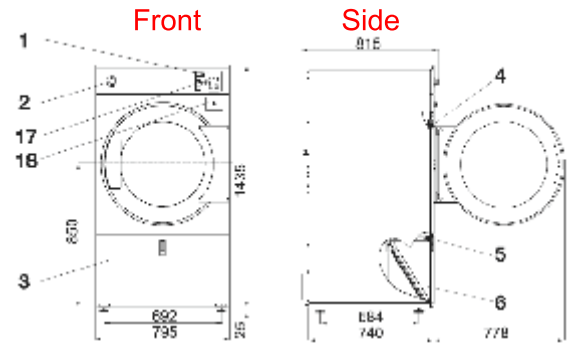

Back (Gas Model)

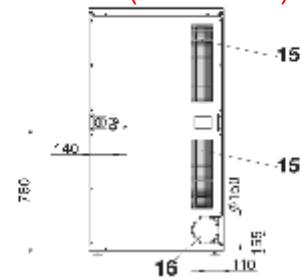

Back (Electric Model)

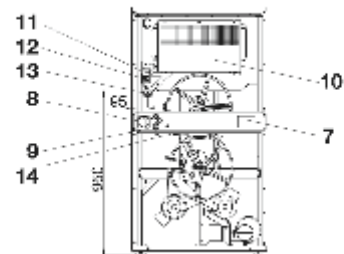

- 1 Programmer
- 2 Emergency stop button  
(not applicable for version with coin meter)
- 3 Lint screen cover
- 4 Door lock microswitch
- 5 Lint cover microswitch
- 6 Lint screen
- 7 Name plate
- 8 Main switch
- 9 Main power supply
- 10 Heating chamber
- 11 Gas valve (G models only)
- 12 Pressure regulator (G models only)
- 13 Gas supply (G models only)
- 14 Air flow switch
- 15 Vents
- 16 Exhaust piping
- 17 Coin meter (version with coin meter)
- 18 Coin box (version with coin meter)

Distributor



## Warwick Dryers Ltd

Head Office  
 Ashbank House, 1 Sadler Forster Way, Teesside Industrial  
 Estate, Thornaby, TS17 9JY  
 Tel : 01642 768 996 Fax: 01642 768 999

Regional Office  
 1 Grice Street, West Bromwich, West Midlands, B70 7EZ  
 Tel : 0121 553 0800 Fax : 0121 553 0888

Email : [info@warwickdryers.co.uk](mailto:info@warwickdryers.co.uk)